

CH240 and CH245 High Band VHF Hybrids

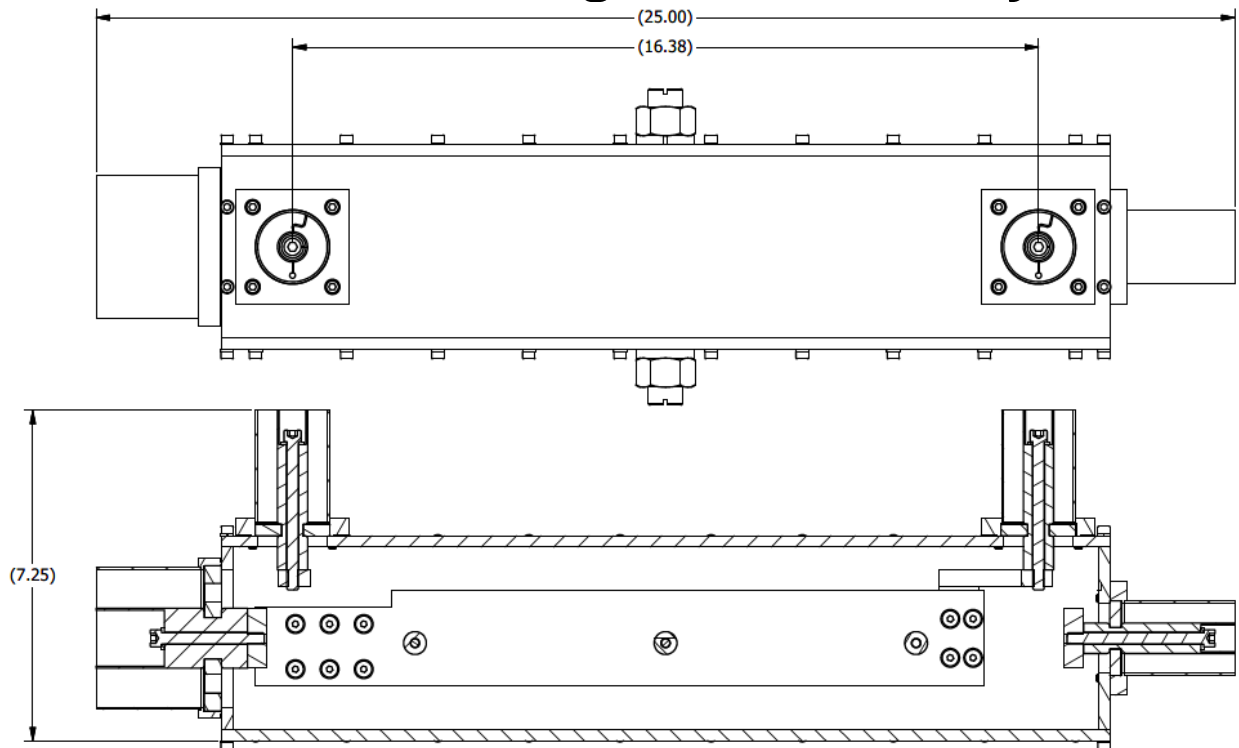

Model CH240 and CH245 High Band VHF Hybrid outline drawing. Dimension listed are in inches.

Specifications

CH240 High Band VHF 3.0 dB Hybrid

Frequency Range:	174 to 216 MHz
Output Power Rating:	20 kW average power
Input VSWR:	1.05 : 1 or better over channel
Coupling:	3.01 dB +/- 0.1 dB over channel
Input Isolation:	32 dB min.
Inputs:	1-5/8-inch, 50 ohm unflanged flush FastLine compatible
Output:	3-1/8-inch, 50 ohm unflanged flush FastLine compatible
Load Port:	1-5/8-inch, 50 ohm unflanged flush FastLine compatible
Weight:	15.60 pounds

CH245 High Band VHF 3.68/2.43 dB Hybrid

Frequency Range:	174 to 216 MHz
Output Power Rating:	20 kW average power
Input VSWR:	1.05 : 1 or better over channel
Coupling:	3.68 / 2.43 dB +/- 0.1 dB
Input Isolation:	32 dB min.
Inputs:	1-5/8-inch, 50 ohm unflanged flush FastLine compatible
Output:	3-1/8-inch, 50 ohm unflanged flush FastLine compatible
Load Port:	1-5/8-inch, 50 ohm unflanged flush FastLine compatible
Weight:	15.72 pounds

Electronics Research, Inc. • 7777 Gardner Road • Chandler, IN 47610-9219 • USA
+1 812 925-6000 (tel) • +1 812 925-4030 (fax)

Your Single Source for Broadcast Solutions™ • Call Toll-free at 877 ERI-LINE • Visit Online at www.eriinc.com