

# CH240 and CH245 High Band VHF Hybrids

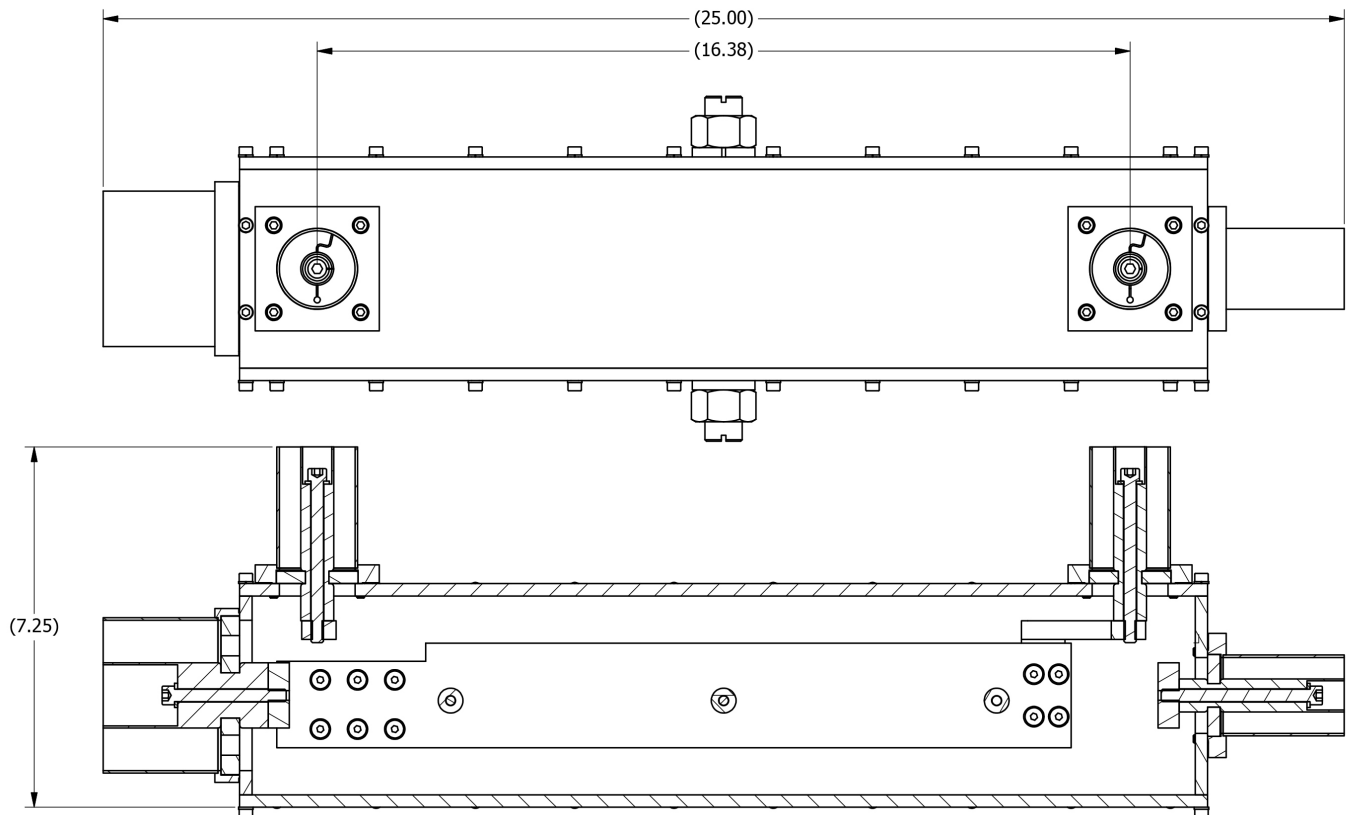

Model CH240 and CH245 High Band VHF Hybrid outline drawing. Dimension listed are in inches.

## Specifications

### CH240 High Band VHF 3.0 dB Hybrid

Frequency Range:	174 to 216 MHz
Output Power Rating:	20 kW average power
Input VSWR:	1.05 : 1 or better over channel
Coupling:	3.01 dB +/- 0.1 dB over channel
Input Isolation:	32 dB min.
Inputs:	1-5/8-inch, 50 ohm unflanged flush FastLine compatible
Output:	3-1/8-inch, 50 ohm unflanged flush FastLine compatible
Load Port:	1-5/8-inch, 50 ohm unflanged flush FastLine compatible
Weight:	15.60 pounds

### CH245 High Band VHF 3.68/2.43 dB Hybrid

Frequency Range:	174 to 216 MHz
Output Power Rating:	20 kW average power
Input VSWR:	1.05 : 1 or better over channel
Coupling:	3.68 / 2.43 dB +/- 0.1 dB
Input Isolation:	32 dB min.
Inputs:	1-5/8-inch, 50 ohm unflanged flush FastLine compatible
Output:	3-1/8-inch, 50 ohm unflanged flush FastLine compatible
Load Port:	1-5/8-inch, 50 ohm unflanged flush FastLine compatible
Weight:	15.72 pounds